

DO YOU KNOW THERE'S A 10 STORY OFFICE & APARTMENT DEVELOPMENT SPANNING MARLTON FROM 39TH STREET TO MLK?

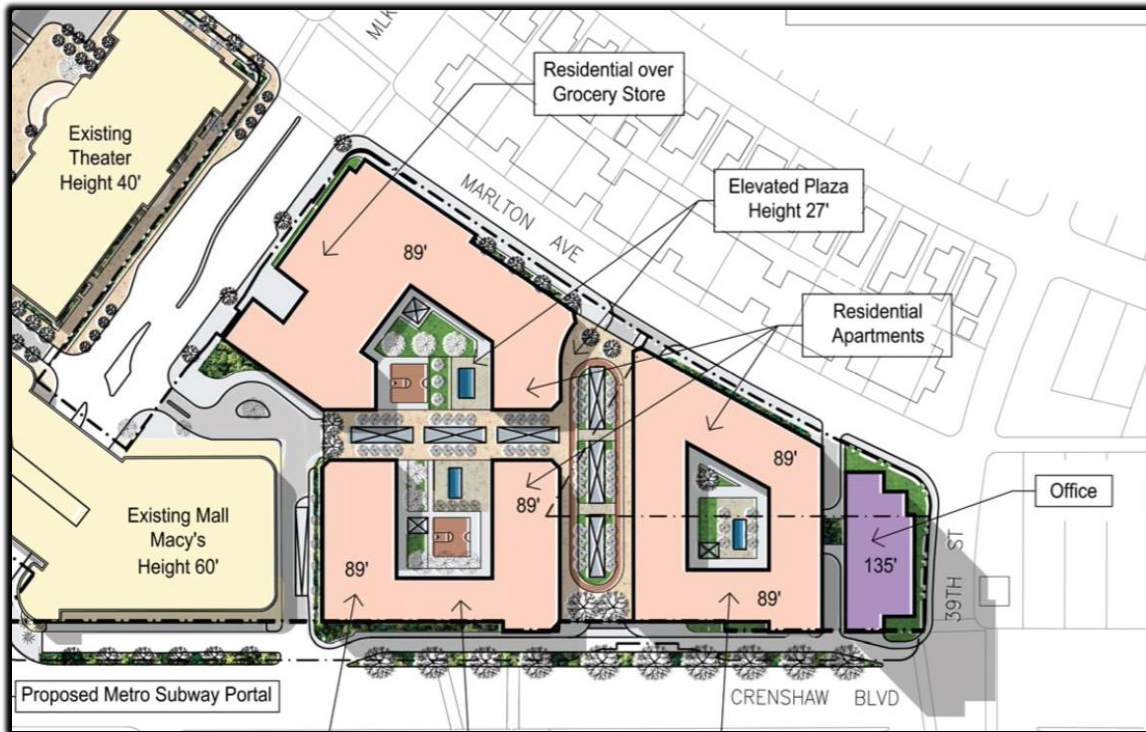

Crenshaw Manor Community Association (CMCA) represents the homeowners and businesses within one mile of the proposed construction. **CMCA is pro development - however traffic congestion, privacy (due to structure height) and air quality are major concerns.**

CMCA requests a commitment from CAPRI Development to resolve the following issues prior to /during the completion of this project:

1. **Traffic Calming** implemented to curb speed and congestion on Buckingham Road & 39th Street.
2. Assessment of Air Quality impact on surrounding residents and **providing relief to sensitive receptors**
3. Increasing LAPD Patrol for Crenshaw Manor
4. Implementation of **Traffic Calming for residential streets** of Victoria, Somerset, Wellington, Virginia & MLK Service Road (speed-bumps, parking restrictions for non-residents, etc)
5. **Installation of privacy landscaping** to preserve aesthetics of surrounding private property views

6. Addressing future concerns brought forth by CMCA to
**ensure our quality of life, health and happiness are not
negatively impacted**

SIGN UP FOR CMCA MEMBERSHIP www.change.org (search: CMCA)